

ORVOJTM
EXAM ENVIRONMENTS
EFFICIENT + ERGONOMIC + VERSATILE

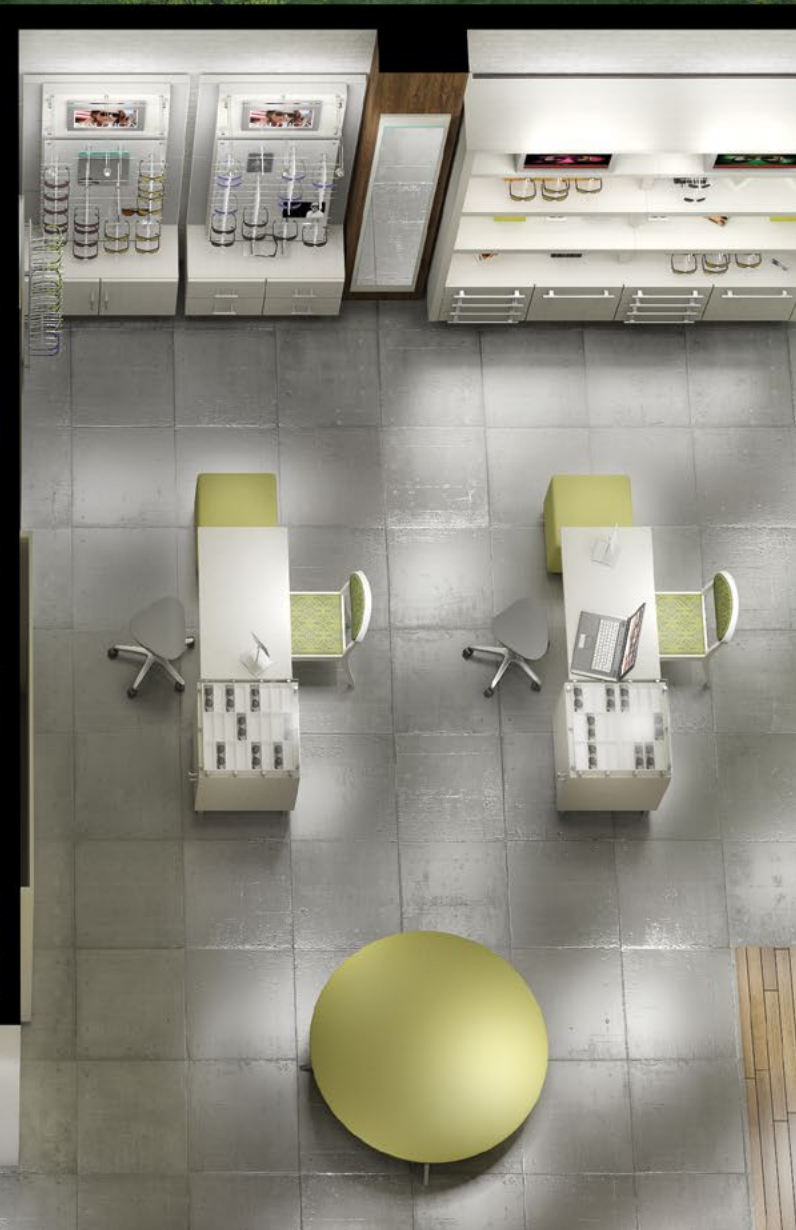



- + EFFICIENT
- + ERGONOMIC
- + VERSATILE

ORVOS Exam Environments allow the eyecare professional to focus on the patient. They are designed to increase your clinical exam's efficiency, while improving patient interaction and your overall productivity.

Deliver an elevated patient experience from the front of the office to the back of the office.

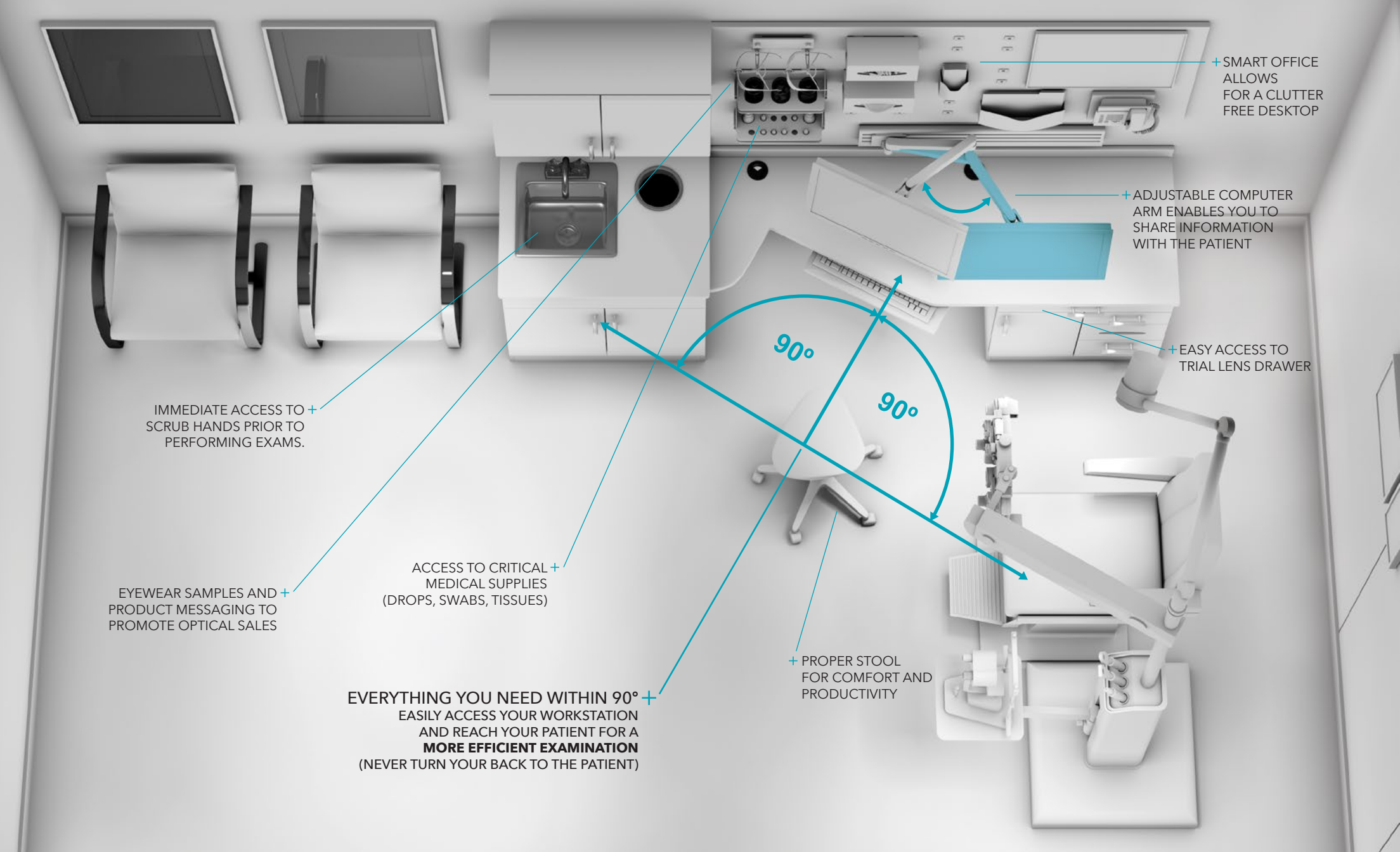

+ SMART OFFICE
ALLOWS
FOR A CLUTTER
FREE DESKTOP

+ ADJUSTABLE COMPUTER
ARM ENABLES YOU TO
SHARE INFORMATION
WITH THE PATIENT

+ EASY ACCESS TO
TRIAL LENS DRAWER

+ PROPER STOOL
FOR COMFORT AND
PRODUCTIVITY

EVERYTHING YOU NEED WITHIN 90° +
EASILY ACCESS YOUR WORKSTATION
AND REACH YOUR PATIENT FOR A
MORE EFFICIENT EXAMINATION
(NEVER TURN YOUR BACK TO THE PATIENT)

ACCESS TO CRITICAL +
MEDICAL SUPPLIES
(DROPS, SWABS, TISSUES)

EYEWEAR SAMPLES AND +
PRODUCT MESSAGING TO
PROMOTE OPTICAL SALES

IMMEDIATE ACCESS TO +
SCRUB HANDS PRIOR TO
PERFORMING EXAMS.

90° OF EFFICIENCY

The ORVOS exam systems are engineered with angled countertop cutouts that position the doctor within a 90° radius of critical controls while maintaining strong patient interaction. The 90° of efficiency increases the doctor to patient face time with direct access to chair and stand controls along with the patient's data.

- + Patient/doctor interaction advantage (never having to turn your back to patient)
- + Lowers muscle fatigue and neck strain moving from patient to computer and instruments.
- + Instant access to trial lenses that are now within arm's reach
- + SMART OFFICE - Critical supplies such as drops, tissues, swabs and gloves are at your fingertips.
- + Direct access to vital patient history (EMR)
- + Articulating computer arm enables you to share information with patient by simply sharing your monitor.

MORE EFFICIENT EXAM = MORE THROUGHPUT= INCREASED REVENUE

(ki-net-ik)

KINETIC

KINETIC Intelligent Exam Consoles are engineered and designed to withstand the vigorous demands of high volume teaching schools, hospitals and institutional environments or the independent doctor's practice. KINETIC features solid surface counter tops, built-in wire management, durable 3mm PVC edges, a hands-free electronic faucet and more.

Simply stated, the finest exam room system in today's market.





KINETIC EXAM DESK I

Exam room system measuring 103" with solid surface countertops and backsplash.

Includes a sink base, trash bin, electronic faucet, wire management cabinet, 3 drawer computer base cabinet, full extension drawer guides, 3mm PVC edging, wall cabinet and SMART OFFICE panel.

SMART OFFICE panel includes Human Scale wall rail and 1 monitor arm, 1 soap/hand sanitizer dispenser, 2 tissue/glove dispensers, 1 file folder holder, 1 phone mount, 1 cork board, 1 pencil holder, 1 metal shelf canister holder, 1 metal shelf drops holder, 1 metal shelf, 1 graphic panel, 5 WAVE™ 360° rotating frame holders.

EXAM1LHKN (right handed doctor with sink on left)

EXAM1RHKN (left handed doctor with sink on right)

EXAM1LHKN Shown with optional keyboard tray
monitor not included



KINETIC EXAM DESK II

Exam room system measuring 101" with solid surface countertops and backsplash.

Includes a sink base, trash bin, electronic faucet, wire management cabinet, 3 drawer computer base cabinet, full extension drawer guides, 3mm PVC edging, wall cabinet and SMART OFFICE panel.

SMART OFFICE panel includes Human Scale wall rail and 1 monitor arm, 1 soap/hand sanitizer dispenser, 2 tissue/glove dispensers, 1 file folder holder, 1 phone mount, 1 cork board, 1 pencil holder, 1 metal shelf canister holder, 1 metal shelf drops holder, 1 metal shelf, 1 graphic panel, 5 WAVE™ 360° rotating frame holders.

EXAM2LHKN (left handed doctor with sink on left)

EXAM2RHKN (right handed doctor with sink on right)

EXAM2RHKN Shown with optional keyboard tray
monitor not included



KINETIC EXAM DESK IV

Exam room desk measuring 63" with solid surface countertops and backsplash.

Includes wire management cabinet, 3 drawer computer base cabinet, full extension drawer guides, 3mm PVC edging, wall cabinet and SMART OFFICE panel.

SMART OFFICE panel includes Human Scale wall rail and 1 monitor arm, 1 soap/hand sanitizer dispenser, 2 tissue/glove dispensers, 1 file folder holder, 1 phone mount, 1 cork board, 1 pencil holder, 1 metal shelf canister holder, 1 metal shelf drops holder, 1 metal shelf, 1 signage holder, 5 WAVE™ 360° rotating frame holders.

EXAM4LHKN (left handed doctor)

EXAM4RHKN (right handed doctor)

*EXAM4RHKN Shown with optional keyboard tray
monitor not included*



KINETIC SINK BASE WITH ELECTRONIC FAUCET

Sink base with solid surface countertop and oversized backsplash. Includes trash bin, electronic faucet, door locks, heavy duty hinges, 3mm PVC edging and water resistant construction.

EXAMSBCKM



+ SMART OFFICE SYSTEM
AND ACCESSORIES
SEE PAGE 36 FOR DETAILS

+ THERMOSTATIC ELECTRONIC CPU
FAN FOR TEMPERATURE CONTROL

WALL CABINET +

+ OPTIONAL MEDICAL CABINET
WITH MEDICAL WASTE
RECEPTICAL AND FLIP DOWN
WORK STATION

HUMAN SCALE +
MONITOR ARM
monitor not included

ELECTRONIC FAUCET +

+ BUILT IN WASTE
DISPOSAL UNIT

SOLID SURFACE +
COUNTERTOP &
BACKSPLASH

+ TRIAL LENS DRAWER

INTEGRATED SOLID +
SURFACE SINK

+ LOCKING MEDICAL PAPER
WASTE DRAWER

5" WATER RESISTANT +
TOE KICK

+ FILE DRAWER

+ COMPUTER STORAGE



3MM
EDGING

+ OPTIONAL
KEYBOARD TRAY

+ WIRE MANAGEMENT SYSTEM
(SHOWN IN OPEN POSITION)
CONCEALS UNSIGHTLY WIRES
AND CORDS

KINETIC

EXAM LANE

SAMPLE CONFIGURATIONS

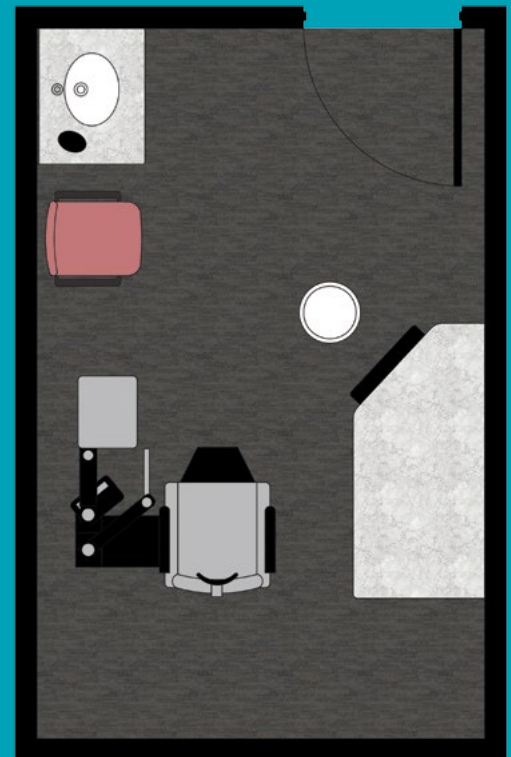
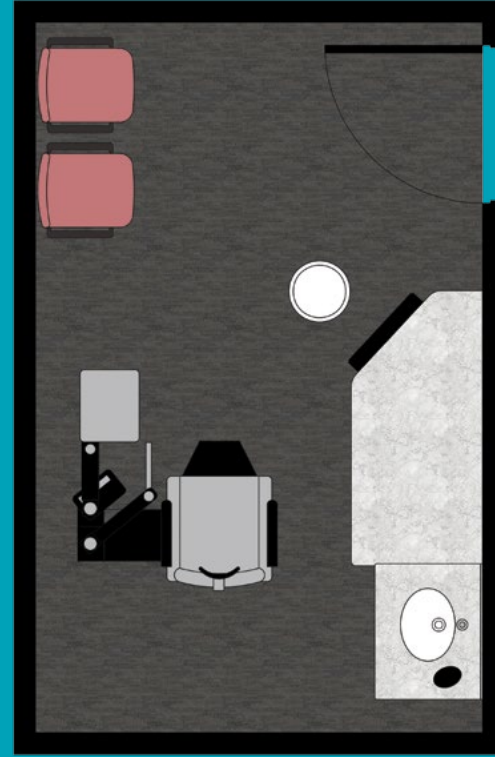
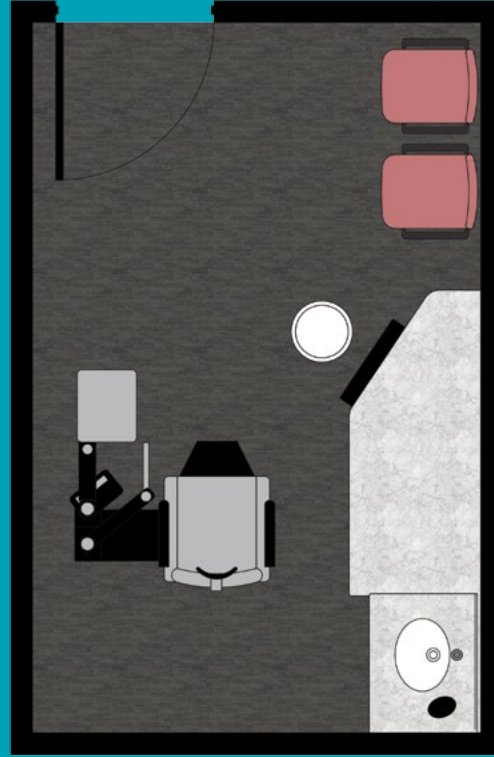
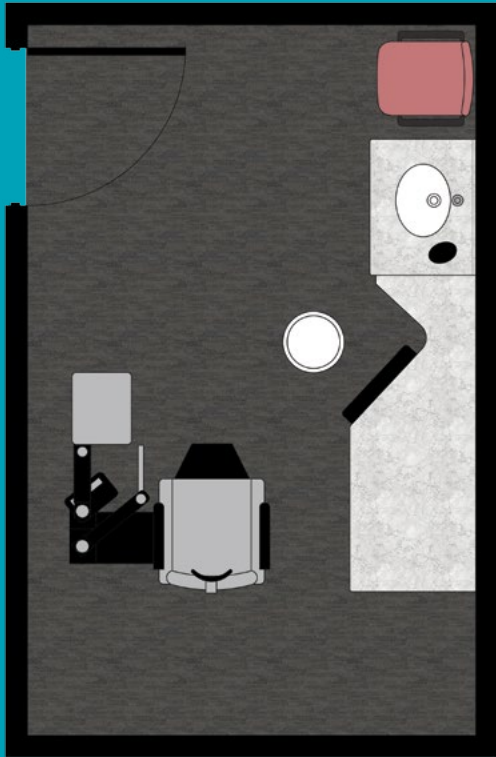

KINETIC Exam Lanes are available in both left and right handed doctor configurations. They can accommodate various room setups to meet your specific examination room requirements.

*Drawings are a representation of furniture and stand placement and may not be an exact representation of your specific dimensional requirements.

(ur-goh)

ERGO

ERGO is an ergonomically engineered exam console that promotes engagement with the patient while allowing you to work in an extremely efficient manner. ERGO features an angled counter top that allows for easier alignment of instruments and movement from work surface to patient.





ERGO

EXAM DESK WITH SINK BASE

Exam room system measuring 100"

Includes standard sink base with stainless steel sink and gooseneck lab faucet with ¼ turn acrylic handles and integrated trash cutout in laminate counter top. Desk features trial lens drawer, tissue dispenser and CPU unit storage.

EXAM1LHEG (right handed doctor with sink on left)

EXAM1RHEG (left handed doctor with sink on right)

EXAM1LHEG Shown with optional keyboard tray Item # D246

Available with wire management system - EXAMWMEG

Available upgrade with wrist blade handle faucet- FAUCETEXAMLEVER



ERGO

EXAM DESK WITH SINK BASE AND TRASH BIN

Exam room system measuring 90"

Includes standard sink base with stainless steel sink and gooseneck lab faucet with ¼ turn acrylic handles and integrated trash cutout in laminate counter top. Desk features trial lens drawer, tissue dispenser and CPU unit storage.

EXAM2RHEG (right handed doctor with sink on right)

EXAM2LHEG (left handed doctor with sink on left)

EXAM2RHEG Shown with optional keyboard tray Item # D246

Available with wire management system - EXAMWMEG

Available upgrade with wrist blade handle faucet- FAUCETEXAMLEVER



ERGO

EXAM DESK WITH SINK BASE

Exam room desk only measuring 83"

Includes standard sink base with stainless steel sink and gooseneck lab faucet with ¼ turn acrylic handles. Desk features trial lens drawer, tissue dispenser and CPU unit storage.

EXAM5RHEG (right handed doctor with sink on right)

EXAM5LHEG (left handed doctor with sink on left)

EXAM5LHEG Shown with optional keyboard tray Item # D246 and optional wire management system Item # EXAMWMEG

Available upgrade with wrist blade handle faucet- FAUCETEXAMLEVER



ERGO

EXAM DESK WITH SINK BASE AND STORAGE CABINET

Exam room system measuring 117"

Includes standard sink base with stainless steel sink and ¼ turn gooseneck lab faucet with acrylic handles and integrated trash cutout in laminate counter top. Desk features trial lens drawer, tissue dispenser, CPU unit storage and additional full door base cabinet.

EXAM6RHEG (right handed doctor with sink on right)

EXAM6LHEG (left handed doctor with sink on left)

EXAM6RHEG Shown with optional keyboard tray Item # D246

Available with wire management system - EXAMWMEG

Available upgrade with wrist blade handle faucet- FAUCETEXAMLEVER



ERGO

EXAM DESK WITH SINK BASE AND SCRIBE STATION

Exam system measuring 120" with integrated scribe station

Includes standard sink base with stainless steel sink and gooseneck lab faucet with ¼ turn acrylic handles and integrated trash cutout in laminate counter top. Desk features extended countertop for scribe, trial lens drawer, tissue dispenser and CPU unit storage.

EXAM7RHEG (right handed doctor with sink on right)

EXAM7LHEG (left handed doctor with sink on left)

EXAM7RHEG Shown with optional keyboard tray Item # D246

and optional wire management system Item # EXAMWMEG

Available upgrade with wrist blade handle faucet - FAUCETEXAMLEVER



ERGO

EXAM DESK

Exam room desk only measuring 60"

Desk features trial lens drawer, tissue dispenser and CPU unit storage.

EXAM4RHEG (right handed doctor)

EXAM4LHEG (left handed doctor)

EXAM4RHEG Shown with optional keyboard tray Item # D246

and optional wire management system Item # EXAMWMEG

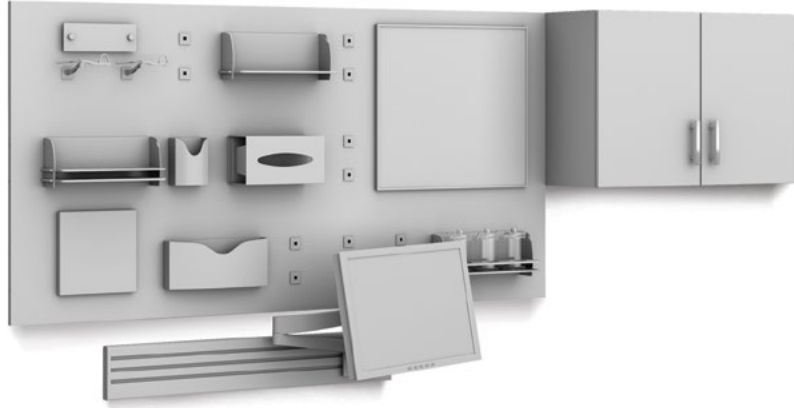

ERGO SMART OFFICE

SMART OFFICE panel includes 1 tissue/glove dispenser, 1 file folder holder, 1 phone mount, 1 cork board, 1 pencil holder, 1 metal shelf canister holder, 1 metal shelf drops holder, 1 metal shelf, 1 graphic panel holder, 2 accessory hooks and 5 WAVE™ 360 rotating frame holders.

EXAMSOEG

Shown with optional monitor arm and rail Item # D195 & D238

Shown with optional wall cabinet- Item # EXAMWEG

monitor not included



ERGO SINK BASE

Sink Base with integrated trash bin.

Sink Base with stainless steel sink and gooseneck lab faucet with ¼ turn acrylic handles and integrated trash cutout in laminate counter top.

EXAM10LHEG (trash on right of sink)

EXAM10RHEG (trash on left of sink)

EXAM11EG (without trash bin)

EXAM10LHEG Shown

Available upgrade with wrist blade handle faucet- FAUCETEXAMLEVER

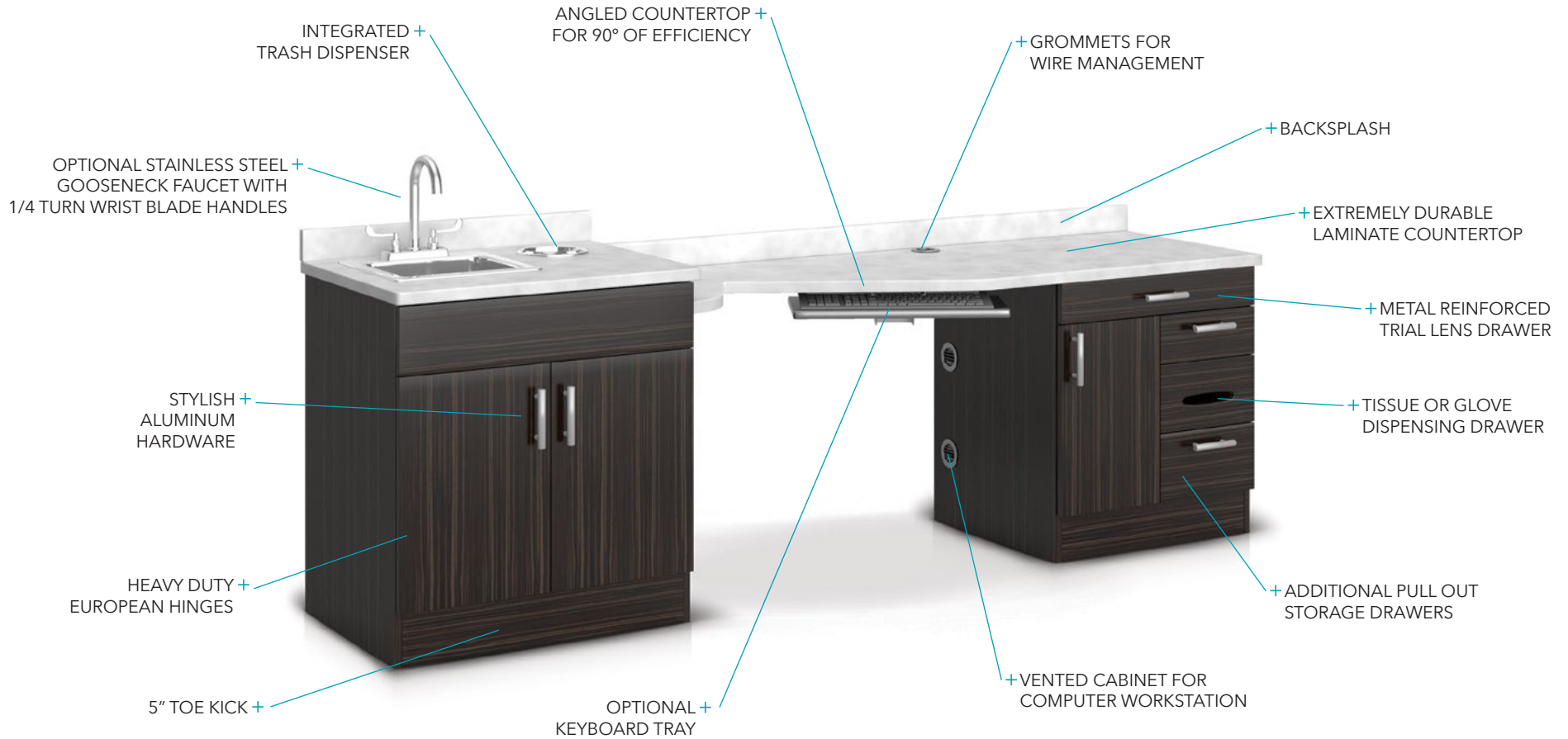

ERGO

EXAM LANE

SAMPLE CONFIGURATIONS

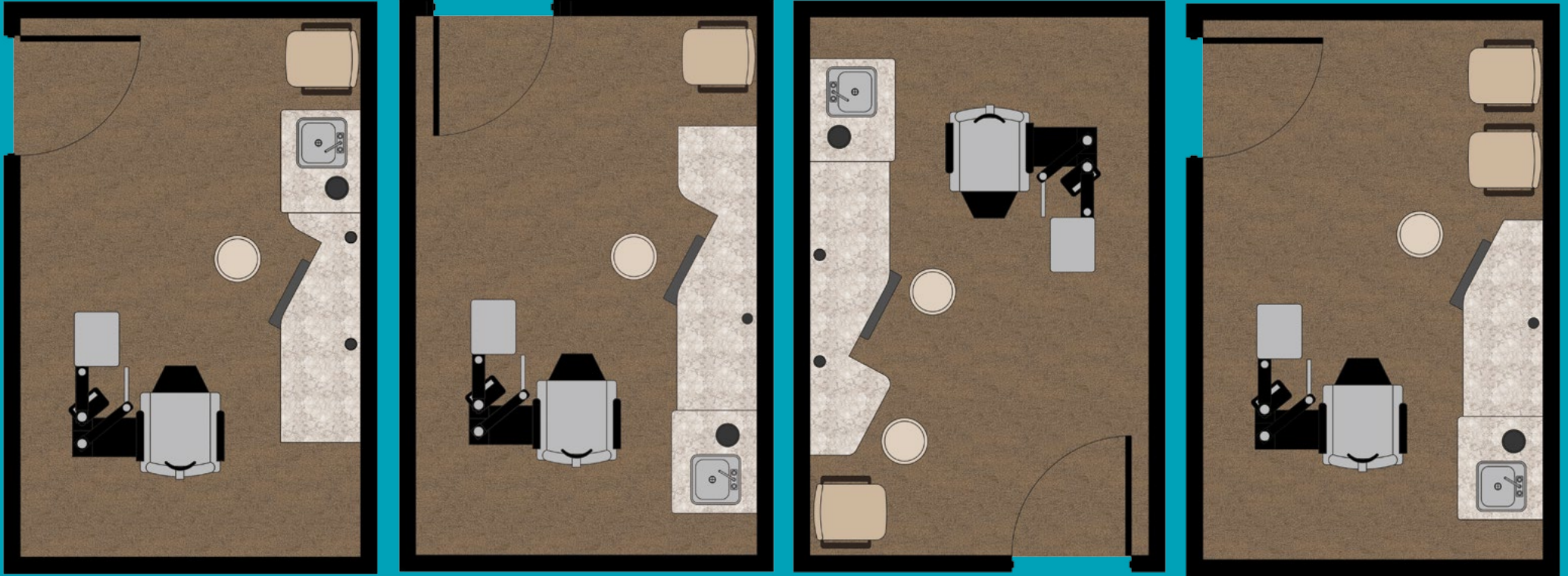

ERGO Exam Lanes are available in both left and right handed doctor configurations. They can accommodate various room setups to meet your specific examination room requirements.

*Drawings are a representation of furniture and stand placement and may not be an exact representation of your specific dimensional requirements.

(veh-lah)

VELA

Angles and contemporary lines combine to make the VELA exam series a seamless exam lane system. VELA features wire management, a recessed toe kick and integrated sink options. Add the SMART OFFICE system to increase functionality.





VELA

EXAM DESK WITH SINK BASE AND TRASH BIN

Exam room system measuring 99" with laminate countertops and backsplash.

Includes a sink base with trash bin, stainless steel gooseneck faucet with ¼ turn wrist blade handles, wire management panel, trial lens drawer and 2 door storage base.

EXAM1LHVE (right handed doctor with sink on left)

EXAM1RHVE (left handed doctor with sink on right)

EXAM1LHVE Shown with optional keyboard tray Item # D246

Available with solid surface countertop



VELA

EXAM DESK WITH SINK BASE AND TRASH BIN

Exam room system measuring 99" with laminate countertops and backsplash.

Includes a sink base with trash bin, stainless steel faucet with ¼ turn wrist blade handles, wire management panel, trial lens drawer and 2 door storage base.

EXAM2RHVE (right handed doctor with sink on right)

EXAM2LHVE (left handed doctor with sink on left)

EXAM2RHVE Shown with optional keyboard tray Item # D246

Available with solid surface countertop



VELA

EXAM DESK WITH SINK BASE

Exam room system measuring 96" with laminate countertops and backsplash.

Includes a sink base with stainless steel gooseneck faucet with ¼ turn wrist blade handles, wire management panel, trial lens drawer and 2 door storage base.

EXAM5RHVE (right handed doctor with sink on right)

EXAM5LHVE (left handed doctor with sink on left)

EXAM5RHVE Shown with optional keyboard tray Item # D246

Available with solid surface countertop



VELA

EXAM DESK WITH SCRIBE AND SINK BASE WITH TRASH BIN

Exam room system measuring 120" with laminate countertops and backsplash.

Features scribe station and sink base with trash bin, stainless steel gooseneck faucet with ¼ turn wrist blade handles, wire management panel, trial lens drawer and 2 door storage base.

EXAM7RHVE (right handed doctor with sink on right)

EXAM7LHVE (left handed doctor with sink on left)

EXAM7RHVE Shown with optional keyboard trays Item # D246

Available with solid surface countertop



VELA

EXAM DESK WITH SCRIBE AND SINK BASE

Exam room system measuring 112" with laminate countertops and backsplash.

Includes a sink base with stainless steel faucet with ¼ turn wrist blade handles, wire management panel, trial lens drawer and 2 door storage base.

EXAM8RHVE (right handed doctor with sink on right)

EXAM8LHVE (left handed doctor with sink on left)

EXAM8RHVE Shown with optional keyboard tray Item # D246

Available with solid surface countertop



VELA

EXAM DESK WITH SCRIBE

Exam desk with scribe measuring 89" with laminate countertops and backsplash.

Features scribe station, wire management panel, trial lens drawer and 2 door storage base.

EXAM9RHVE (right handed doctor)

EXAM9LHVE (left handed doctor)

EXAM9RHVE Shown with optional keyboard trays Item # D246

Available with solid surface countertop



VELA EXAM DESK

Exam room measuring 74" with laminate countertops and backsplash.

Features wire management panel and trial lens drawer in 2 door storage base.

EXAM4RHVE (right handed doctor)

EXAM4LHVE (left handed doctor)

EXAM4RHVE Shown with optional keyboard tray Item # D246

Available with solid surface countertop



VELA WALL CABINET

4 Door wall cabinet with matching wrap around trim.

EXAMWC70VE

SMART OFFICE

SMART OFFICE panel includes 1 soap/hand sanitizer dispenser, 1 tissue/glove holder, 1 file folder holder, 1 metal shelf canister holder and 1 metal shelf drops holder.

EXAMSO70VE

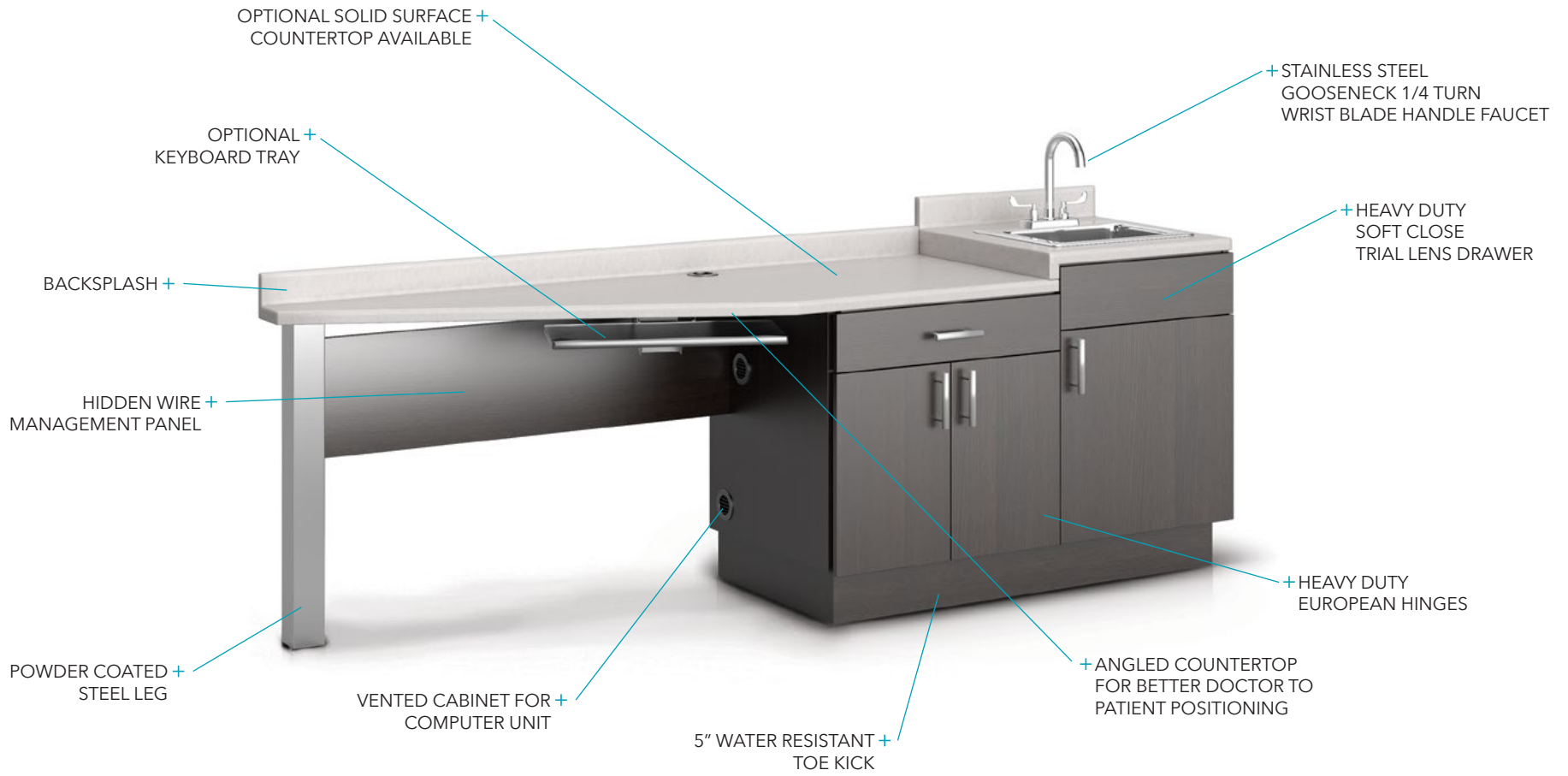

OPTIONAL SOLID SURFACE +
COUNTERTOP AVAILABLE

OPTIONAL +
KEYBOARD TRAY

+ STAINLESS STEEL
GOOSENECK 1/4 TURN
WRIST BLADE HANDLE FAUCET

+ HEAVY DUTY
SOFT CLOSE
TRIAL LENS DRAWER

BACKSPLASH +

HIDDEN WIRE +
MANAGEMENT PANEL

+ HEAVY DUTY
EUROPEAN HINGES

POWDER COATED +
STEEL LEG

VENTED CABINET FOR +
COMPUTER UNIT

5" WATER RESISTANT +
TOE KICK

+ ANGLED COUNTERTOP
FOR BETTER DOCTOR TO
PATIENT POSITIONING

VELA

EXAM LANE

SAMPLE CONFIGURATIONS

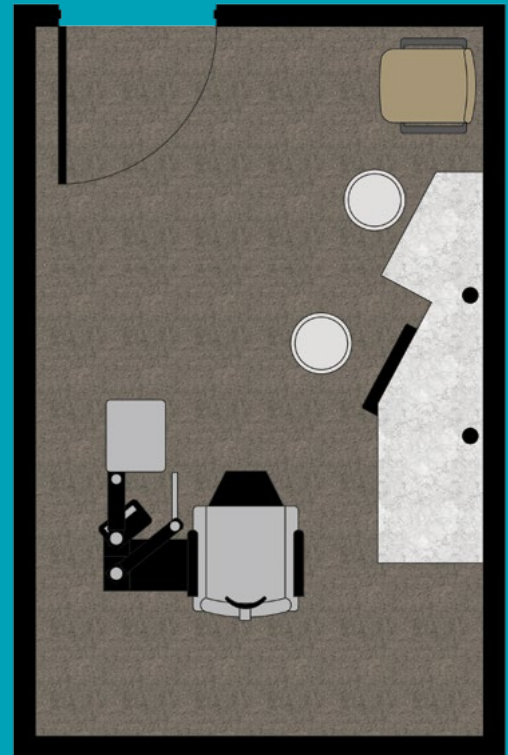
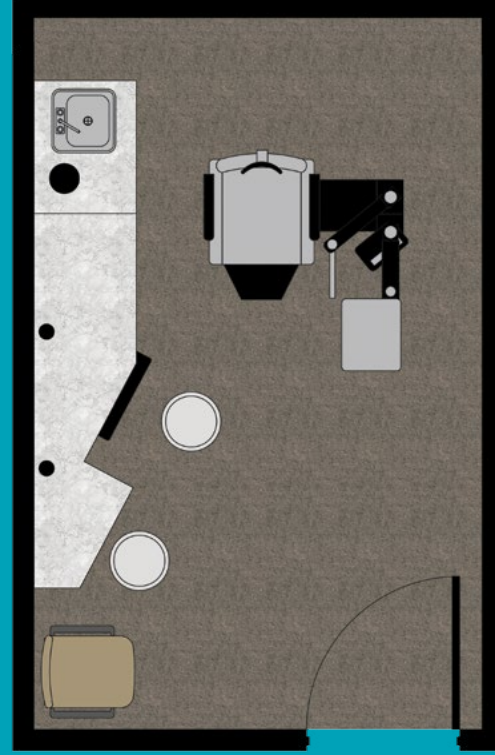
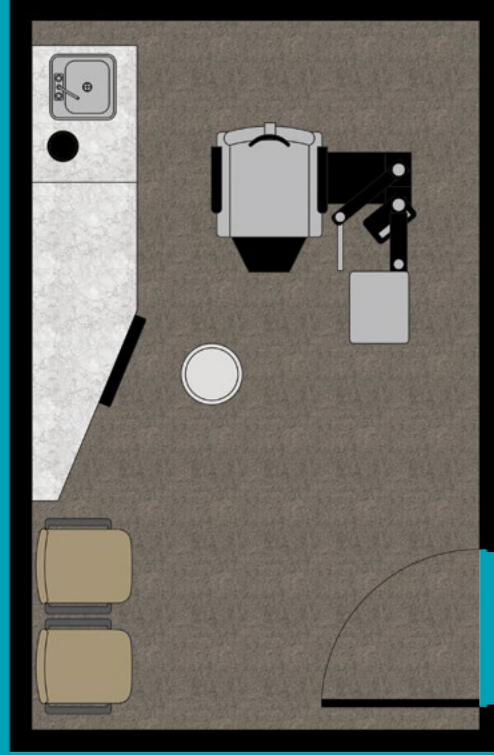
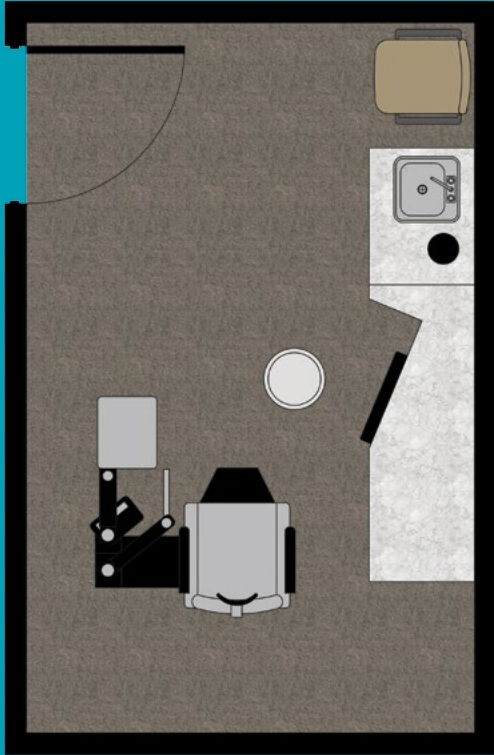

VELA Exam Lanes are available in both left and right handed doctor configurations. They can accommodate various room setups to meet your specific examination room requirements.

*Drawings are a representation of furniture and stand placement and may not be an exact representation of your specific dimensional requirements.

(proh-fahyls)

PROFILES

The PROFILES exam desk is a stylish way to extend the decor of your office environment into your exam lanes. The softly curved counter top creates a nice design element for added workspace and comfort. PROFILES exam sink base and full exam desk with sink are available. All include a 4" backsplash, pencil drawer, and trial lens drawer (trial lens insert not included).





PROFILES

EXAM DESK

Exam desk with trial lens drawer (insert not included), 1 pencil drawer and file drawer. Features curved laminate countertops with curved 4" backsplash.

EDPR



PROFILES

EXAM COMBO DESK

Exam desk with integrated stainless steel sink and gooseneck faucet with ¼ turn acrylic handles. Desk features trial lens drawer (insert not included), 1 pencil drawer, 1 file drawer and curved laminate countertop with curved 4" backsplash.

EDCPR

Other products available...Sink base only and SMART OFFICE System

PROFILES

EXAM LANE SAMPLE CONFIGURATIONS

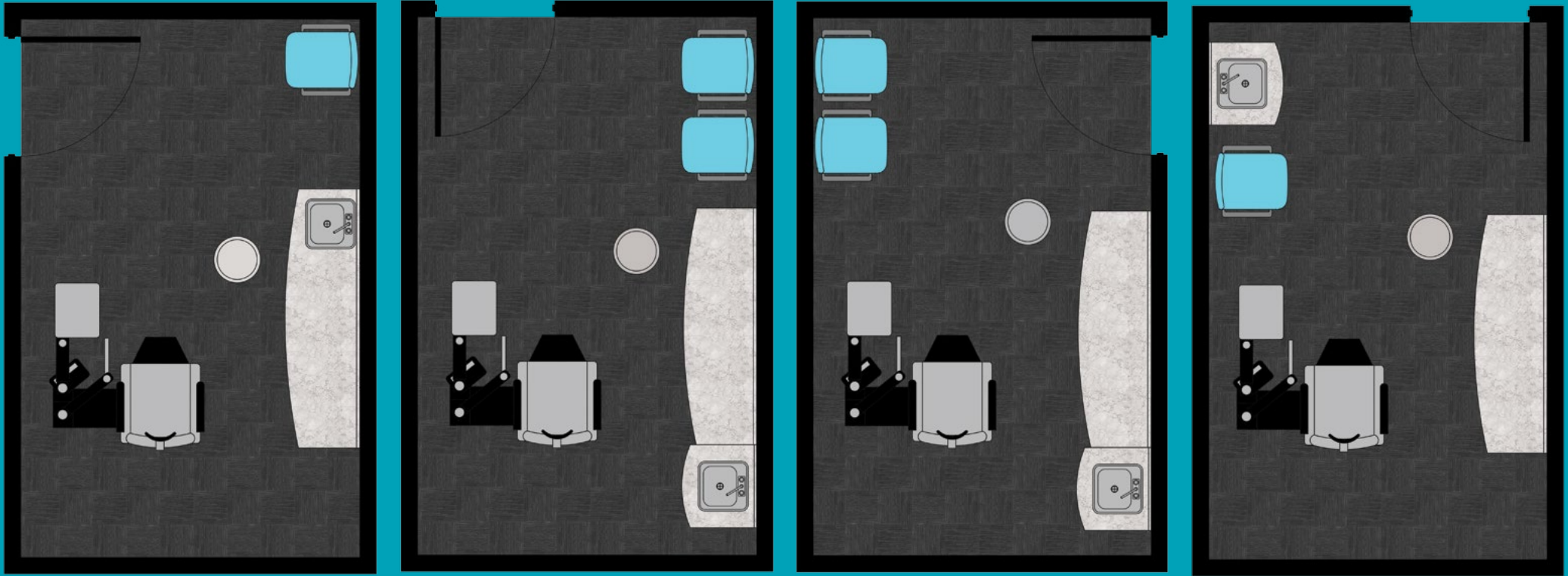

PROFILES Exam Lanes are available in both left and right handed doctor configurations. They can accommodate various room setups to meet your specific examination room requirements.

*Drawings are a representation of furniture and stand placement and may not be an exact representation of your specific dimensional requirements.

(mey-triks)

MATRIX

The MATRIX exam and MATRIX QUICKSHIP exam desks are designed to meet the needs and functions you demand in an affordable exam lane solution. The desk features a durable laminate counter top, pencil drawer and file drawer along with the ability to hold a trial lens insert. The MATRIX QUICKSHIP exam desks are available for immediate delivery.

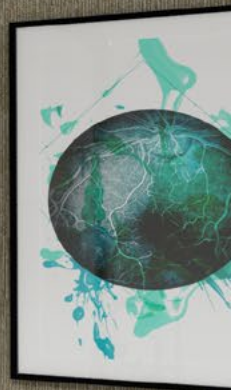



MATRIX

EXAM COMBO DESK

Exam desk with integrated stainless steel sink and gooseneck faucet with ¼ turn acrylic handles. Desk features trial lens drawer (insert not included), 2 pencil drawers, 1 file drawer and laminate countertop with 4" backsplash.

ESBM2004VP

Also available for immediate delivery as part of QUICKSHIP program



MATRIX

EXAM DESK AND SINK BASE

Exam desk that features trial lens drawer (insert not included), 2 pencil drawers, 1 file drawer and laminate countertop with 4" backsplash. Separate sink base available with stainless steel sink and gooseneck faucet with ¼ turn acrylic handles.

EDMVP (desk)

ESBMVP (sink base)

Also available for immediate delivery as part of QUICKSHIP program

MATRIX

EXAM LANE SAMPLE CONFIGURATIONS

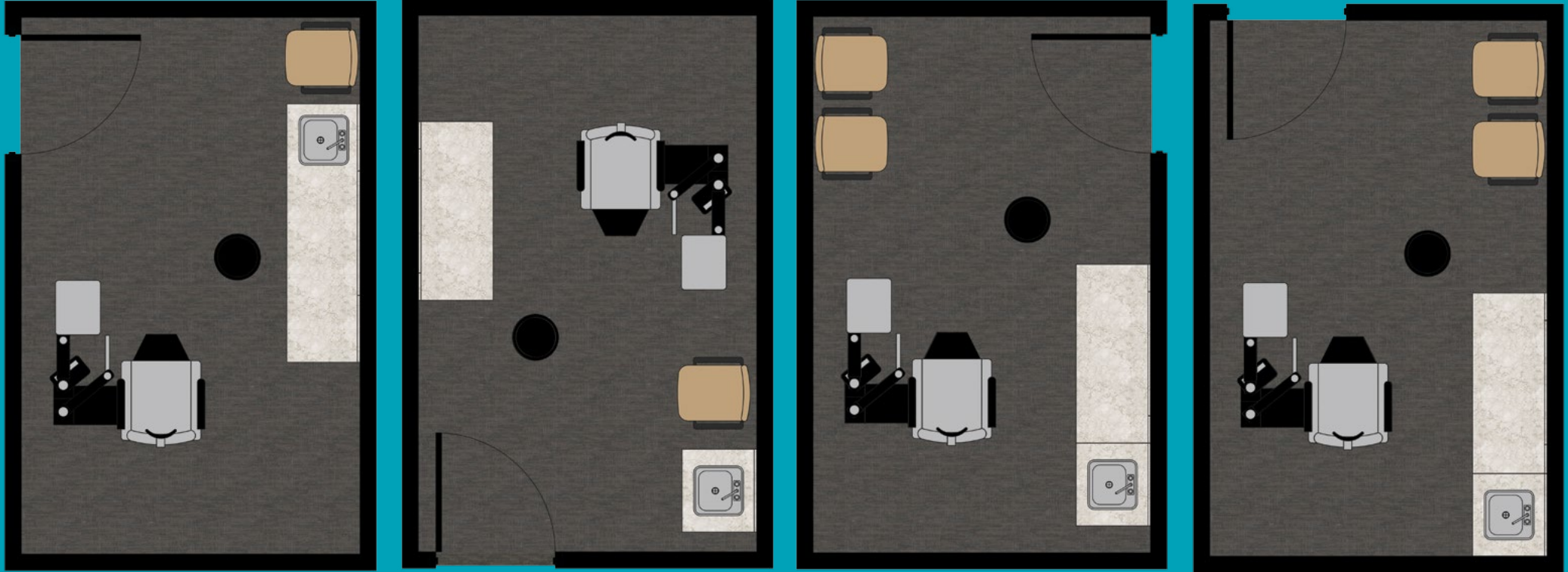

MATRIX Exam Lanes are available in both left and right handed doctor configurations. They can accommodate various room setups to meet your specific examination room requirements.

*Drawings are a representation of furniture and stand placement and may not be an exact representation of your specific dimensional requirements.

+ SMART OFFICE

Make your day easier. The SMART OFFICE system organizes daily use items like eye drops and tissues, along with paperwork, to make your lane more efficient. It gives you the opportunity to promote recommendations for various eyewear prescriptions and lifestyle applications along with second pair options. It's an excellent way to increase sales and doctor-recommended services. Various components and configurations are available to help maintain a clutter-free desktop.





SMART OFFICE

3 PANEL KIT

Kit includes 3 SMART OFFICE panels, 1 pencil/literature holder, 1 file holder, 1 graphic panel holder, 2 tissue/glove dispensers, 1 drop holder, 1 canister holder, 1 metal shelf, 5 WAVE 360™ locking frame holders and 2 accessory hooks.

SMARTOFFICE3PANEL



SMART OFFICE

2 PANEL KIT

Kit includes 2 SMART OFFICE panels, 1 pencil/literature holder, 1 file holder, 1 graphic panel holder, 1 tissue/glove dispenser, 1 drop holder, 1 canister holder, 1 metal shelf, 5 WAVE 360™ locking frame holders and 2 accessory hooks.

SMARTOFFICE2PANEL

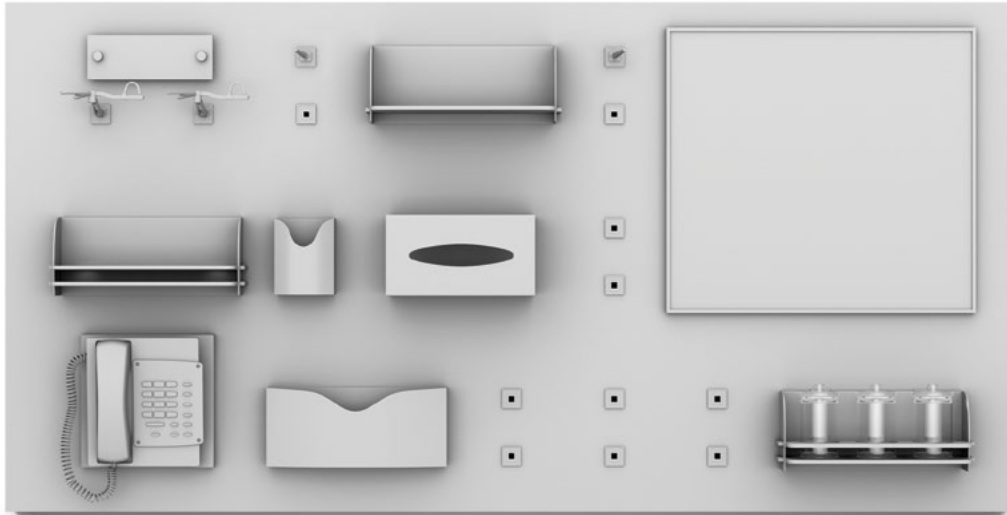

SMART OFFICE

FULL WALL PANEL

Kit includes 1 SMART OFFICE panel, 1 pencil/literature holder, 1 cork board, 1 file holder, 1 graphic panel holder, 1 tissue/glove dispenser, 1 drop holder, 1 canister holder, 1 metal shelf, 1 phone mount, 5 WAVE 360™ locking frame holders and 2 accessory hooks.

EXAMSOEG

phone not included



SMART OFFICE

NARROW PANEL

Kit includes 1 horizontal SMART OFFICE panel, 1 pencil/literature holder, 1 cork board, 1 file holder, 1 graphic panel holder, 1 tissue/glove dispenser, 1 drop holder, 1 canister holder, 1 metal shelf, 1 phone mount, 5 WAVE 360™ locking frame holders and 2 accessory hooks.

EXAMSO70VE



METAL SHELF WITH ACRYLIC CANISTERS

D191



METAL SHELF DROPS HOLDER

D194



METAL SHELF

D263



SOAP DISPENSER

D190



SHARPS DISPOSAL UNIT

D193



TISSUE/GLOVE DISPENSER

D192



PENCIL/LITERATURE HOLDER

D240

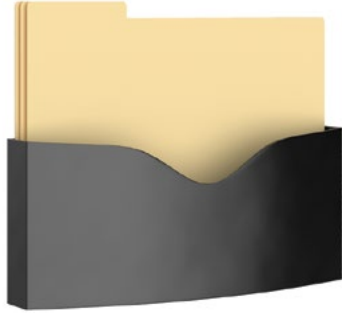

FILE HOLDER BLACK

D129



BULLETIN BOARD

D273



MONITOR RAIL

D238 (36" rail)
D239 (42" rail)

MONITOR ARM

D195

monitor not included



PHONE MOUNT

D272

phone not included



GRAPHICS PANEL KIT 8.5 X 3

D208



WAVE 360° LOCKING FRAME
HOLDERS SET OF 5

D86



ACCESSORY HOOK
SET OF 10

D85

+ OPTICAL LAB KITS

Add increased functionality to your lab with Eye Designs' Optical Lab Kits. These intelligently designed wall mounted panels with tool holders, shelves, hooks and bins allow you to remove counter top clutter and organize your lab in style. The Optical Lab Kits are available in three different configurations.

GENERAL CABINETS

Eye Designs produces a large array of standard and custom cabinetry that easily outfits any optical lab, business office, break room or storage areas.



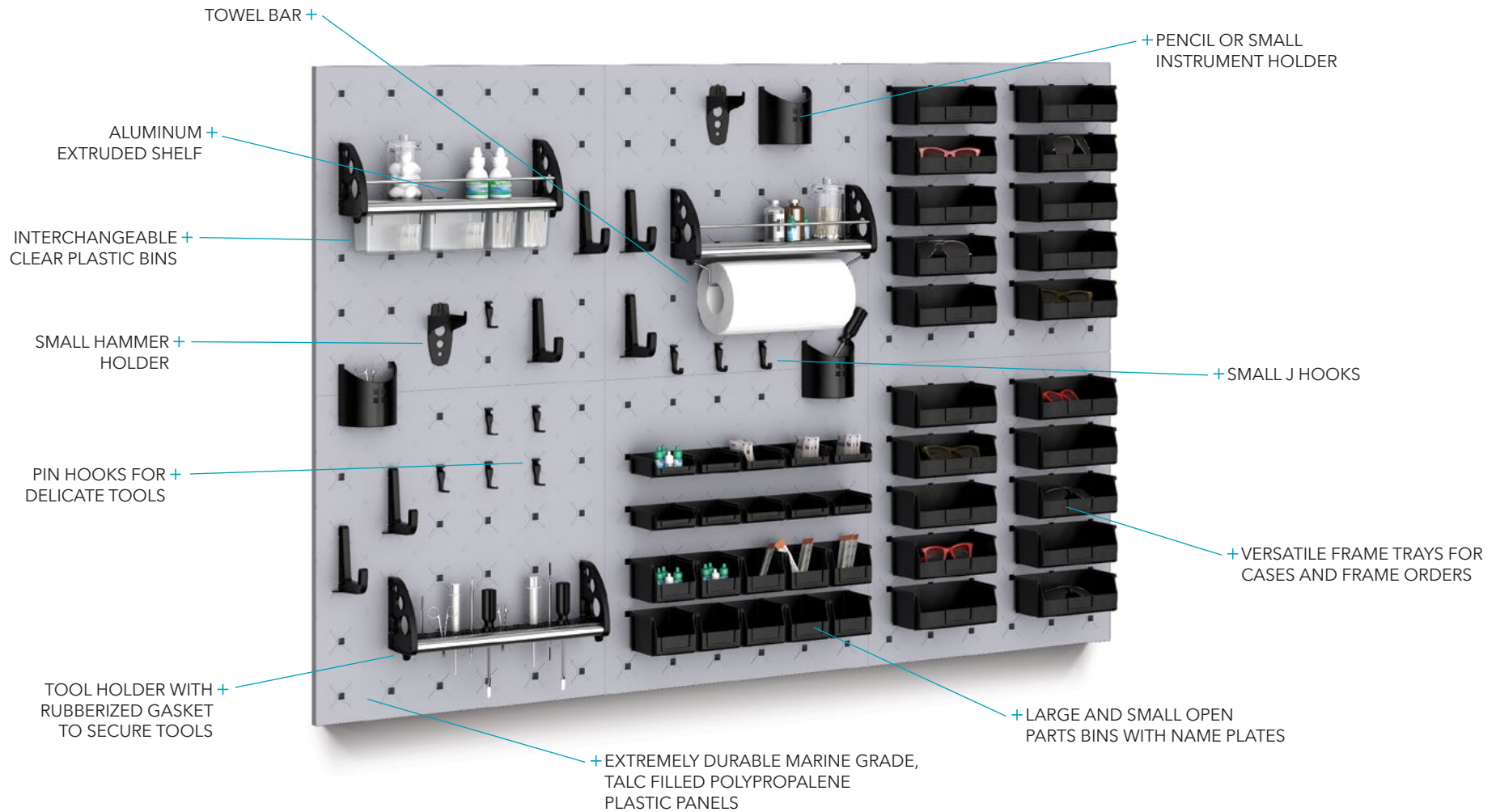



LAB KIT 1 FOR SMALL TOOLS

Kit includes 2 plastic panels, 1 16" small shelf, 2 clear small hanging bins, 2 clear large hanging bins, 2 pencil holders, 1 hammer holder, 2 large J hooks, 6 small pin hooks, 2 long J hooks, 1 16" multi-tool holder.

D235



LAB KIT 2 FOR SMALL PARTS STORAGE AND PAPER TOWELS

Kit includes 2 plastic panels, 1 hammer holder, 2 large J hooks, 6 small J hooks, 1 pencil holder, 10 small open bins, 10 large open bins, 1 16" small shelf with paper towel holder.

D236



LAB KIT 3 FOR FRAME STORAGE AND ORDERS

Kit includes 2 plastic panels,
20 XL open bins.

D237

LIGHTING

Keep your exam lane under the proper light. ORVOS offers an optional lighting package that features wireless remote dimmers and switches. The switches can be integrated into any of the exam lane systems, or can be controlled with a tabletop pedestal remote.



WIRELESS GENERAL LIGHTING SWITCH



WIRELESS DIMMABLE LIGHTING SWITCH



GENERAL LIGHT REMOTE



DIMMABLE LIGHT REMOTE



TABLE TOP PEDESTAL

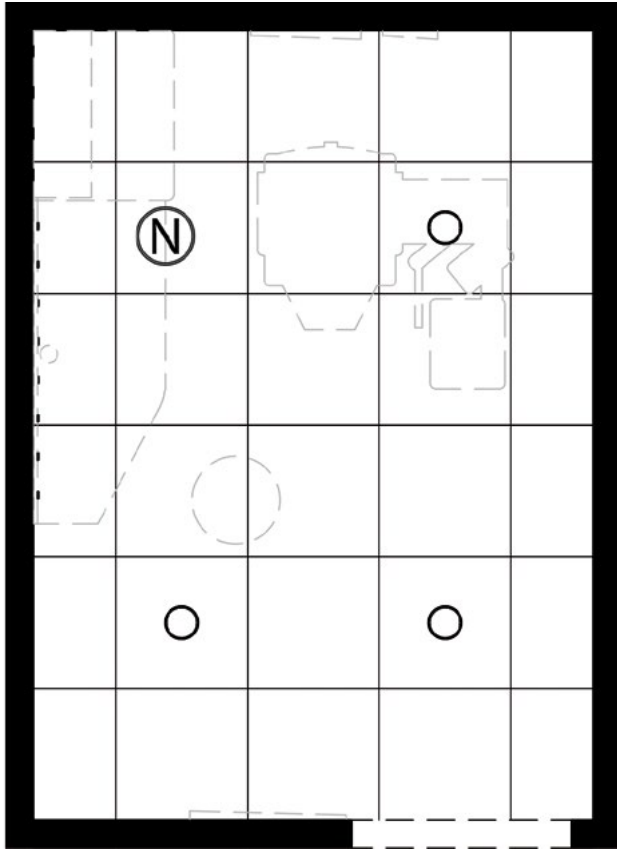

PACKAGE 1

- 4- Par 38 Recessed LUM Can Lights with LED Bulbs
- 1- Switch with Wireless Control for General Lighting
- 1- Dimmer Switch with Wireless Control for Dimmable Light

EL - 100 with integrated wireless remote
 EL - 101 with pedestal wireless remote

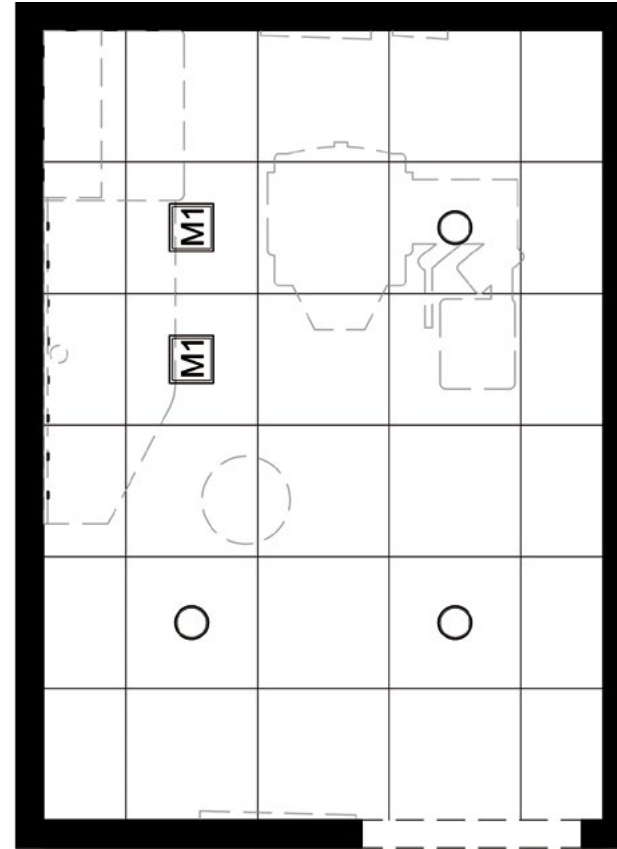

PACKAGE 2

- 3- Par 38 Recessed LUM Can Lights with LED Bulbs
- 2- Par 38 LUM Recessed Modulinear Fixture with LED Bulbs
- 1- Switch with Wireless Control for General Lighting
- 1- Dimmer Switch with Wireless Control for Dimmable Lights

EL - 102 with integrated wireless remote
 EL - 103 with pedestal wireless remote

STOOLS

Ensure a perfect fit. No matter if you're seeing one patient or an entire day of them, your exam room stool is vital part of your daily routine. By making sure the stool addresses your particular needs, you will feel more productive, less fatigue, and comfortable throughout the day. ORVOS offers a series of ergonomically designed and engineered chairs that promote proper posture, allow proper adjustment and offer stability. Many options and configurations are available so be sure to explore all of the options to find your perfect fit.

Styles, materials and options vary by manufacturer. Please contact your ORVOS Consultant for more information.



STOOL WITH TABLET ARM

A 5 prong round stool on casters combined with a small tablet extension. Excellent for quick patient consultations and note taking.



CLASSIC EXAM STOOL

The standard in clinical form and function, these classic round 5 prong stools are extremely durable. The standard pneumatic height adjustment makes for easy repositioning. Optional backrests are available.



ERGONOMIC SADDLE

The contoured triangular cushion of the saddle stool promotes healthy posture and multiple sitting positions for extreme comfort. The saddle seat lowers pressure points for long term comfort and allows users to get closer to their work.



WEDGE

The triangular seat means you are not forced to adopt a 90° sitting angle, but are given the space to adopt a position where knees are lower than the hips. This “open hip” angle makes it easier to maintain good posture while working. The backrest is small and round, giving precise support to the lower back and ensuring maximum freedom of movement.



PROFESSIONAL SERVICES DISPLAY

WALL MOUNTED PANEL 28.75" w x 90" h

Includes 8 blank acrylic interchangeable graphic panels and 1 larger graphic panel for header. Ideal for listing services provided or brands offered.

MOSBB28_5MF

ORVOS EXAM ENVIRONMENTS USER LIST

- + SCHEIE EYE INSTITUTE
- + KATZEN EYE GROUP
- + WILMER VISION INSTITUTE
- + MY EYE DR.
- + GRAND RAPIDS OPHTHALMOLOGY
- + UNIVERSITY OF COLORADO, DEPARTMENT OF OPHTHALMOLOGY
- + VANDERBILT UNIVERSITY - DEPARTMENT OF OPHTHALMOLOGY
- + GREENVILLE HEALTH SYSTEM DEPARTMENT OF OPHTHALMOLOGY
- + MONTEFIORE MEDICAL CENTER
- + ALTOONA EYE OPHTHALMOLOGY ASSOCIATES
- + VSP ONSITE CLINICS
- + NORTHERN VIRGINIA DOCTORS OF OPTOMETRY
- + AAFES - VARIOUS LOCATIONS
- + PACIFIC UNIVERSITY SCHOOL OF OPTOMETRY
- + EYE CONSULTANTS OF ARIZONA
- + AVANT-GARDE OPTICAL
- + MANY OTHERS

Custom desk design and fabrication is available. Minimum quantities may apply. Please contact your ORVOS consultant for details.

TIME TO MAKE A CHANGE TO:

- + INCREASE PRODUCTIVITY
- + ENHANCE PERFORMANCE
- + IMPROVE PATIENT CARE

ORVOSEXAM.COM // 800-346-8890

NEED HELP WITH YOUR OPTICAL LAYOUT?
WWW.EYEDESIGNS.COM

opticaldisplays.com

LUM
RETAIL LIGHTING GROUP™

NEW
OFFICE
FINANCING
.com

ORVOJ™
EXAM ENVIRONMENTS

EYE|DESIGNS®
CUSTOM INTERIORS + FURNITURE

VISIT ONLINE TODAY / WWW.ORVOSEXAM.COM
WWW.EYEDESIGNS.COM

800.346.8890 / 220 WEST FIFTH AVENUE COLLEGEVILLE PA 19426



MADE IN



U. S. A.
ED150301

© 2015 EYE DESIGNS, LLC

Versa™ Merchandising System, Wave™ Frame Holder, Wave™ Locking Frame Holder, Wave™ 360° Rotating Frame Holder are Patented with additional Patents pending.
LUM Retail Lighting Group™, FLOT™, Synergy Pro™, Wave™ Frame Holder, Versa™ Clip, Versa™ Disc, Viewpoint, Versa™ Wall, Forma™, Prisma™, Lumen™, Lum Retail Lighting Group™ are all Trademarks of Eye Designs, LLC with additional trademarks pending. The third party trademarks contained herein are the properties of their respective owners. All renderings of products and concepts shown in catalog are property of Eye Designs, LLC and cannot be copied or reproduced without authorization. Specification of products are subject to change without notice.
Some options may be unavailable at time of purchase.

